

# ANTERIOR APPROACH HIP RETRACTORS

Tecomet®'s **Anterior Approach Hip Exposure Instruments** are designed for use with the anterior approach total hip arthroplasty procedure and feature several instruments intended to facilitate the proper exposure during hip replacement surgery.

Retractor designs included:

- Hohmann
- Cobra
- Femoral Neck Elevators

A premium design is also available featuring a silicone handle for ergonomic purposes.

Contact your local Sales Manager or visit [tecomet.com](https://www.tecomet.com) for more information.

3724 North SR 15  
Warsaw, IN 46582 USA  
Phone +1 574.267.8700

[sales@tecomet.com](mailto:sales@tecomet.com)  
[www.tecomet.com](https://www.tecomet.com)

Cat #: 5103-00  
Rev. E  
Printed in the USA ©2023  
Tecomet. All rights reserved.

# ANTERIOR APPROACH HIP RETRACTORS

## Part Numbers



### Curved Hohmann Retractor

Standard, 347mm length	13-088-000
Large, 339mm length	13-090-000
Small, 221mm length	13-089-000
Sharp tip, 348mm length	13-102-000
Blunt tip, 348mm length	13-103-000



### Bent Hohmann Retractor

Sharp tip, 314mm length	13-104-000
Blunt tip, 314mm length	13-105-000
Stub tip, 314mm length	13-101-000



### Double Bent Hohmann Retractor

Standard, 253mm length	13-084-000
Long, 303mm length	13-085-000



### Bent Hohmann Retractor

Standard, 184mm length	13-086-000
Long, 253mm length	13-087-000

# ANTERIOR APPROACH HIP RETRACTORS

## Part Numbers



### AVA Retractor

Sharp tip, 285mm length

13-098-000

Blunt tip, 285mm length

13-091-000



### Acetabular Retractor

Double pronged, 370mm length

13-096-000



### Cobra Retractor

Blunt tip, 343mm length

13-099-000

Blunt tip, 343mm length, narrow, 36mm

13-106-000

Blunt tip, 343mm length, narrow, 30 mm

13-100-000

Blunt tip, 430mm length

13-082-000

Blunt tip, 430mm length, narrow

13-083-000

Blunt tip, 430mm length, wide

13-080-000

Sharp tip, 430mm length, wide

13-081-000



# ANTERIOR APPROACH HIP RETRACTORS

## Part Numbers



### Femoral Neck Elevator

Cupped, 388mm length

13-094-000

Curved, 325mm length

13-095-000

332mm length

13-097-000



### Pelvis Elevator

311mm length

13-107-000



### T-Handle Hip Skid

(standard radel black handle)

T-Handle, 303mm length

13-092-000



### Ligament Teres Cutter

(standard silicone black handle)

243mm length

11-144-000

# ANTERIOR APPROACH HIP RETRACTORS

## Part Numbers

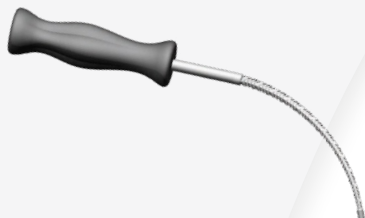

### Curved Canal Finder

(standard silicone black handle)

Blunt tip, 310mm length

10-255-000

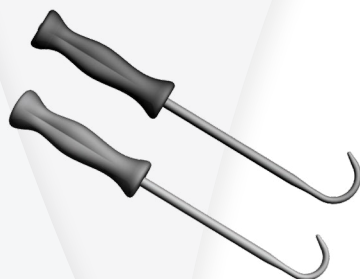

### Bone Hook

Large, 324mm length, 0.750 radius

10-256-000

Small, 321mm length, 0.625 radius

10-257-000



### Femoral Head Corkscrew

Hudson connection, 235mm length

12-061-000

Zimmer/tri-shark connection, 235mm length

12-062-000

Large AD connection, 235mm length

12-066-000

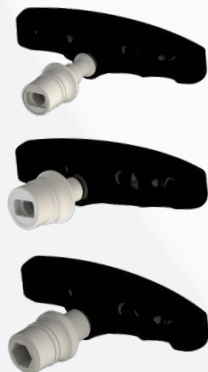

### Silicone T-Handle

Hudson connection

15-588-101

Zimmer/tri-shark connection

15-609-101

Large AD connection

15-612-101